

# Max Lite Window

COMMERCIAL SERIES - 125mm FRAME

## Head & Sill Detail

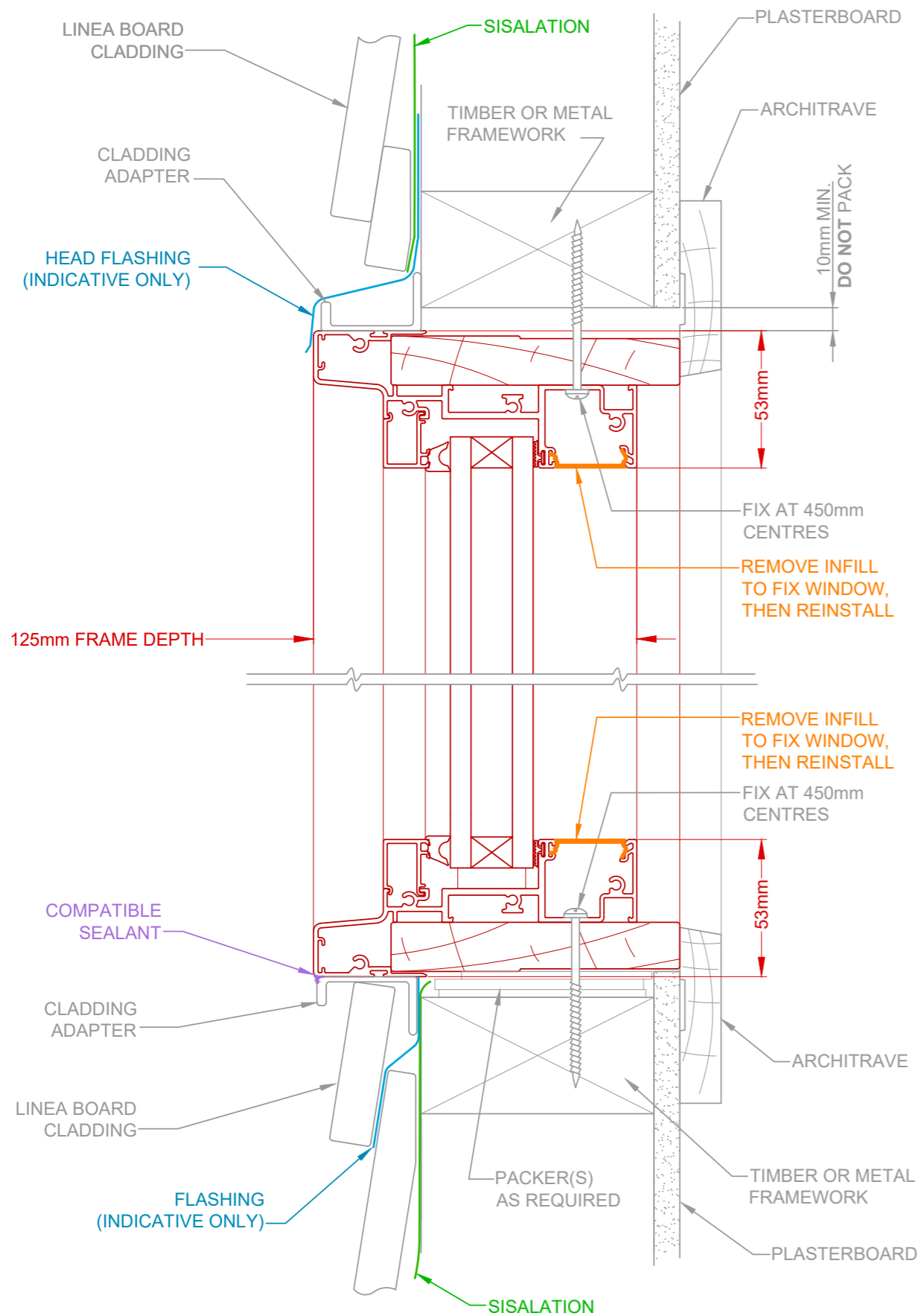

# Lightweight Cladding | Linea Board

TYPICAL BUILDING-IN DETAIL

## Jamb Detail

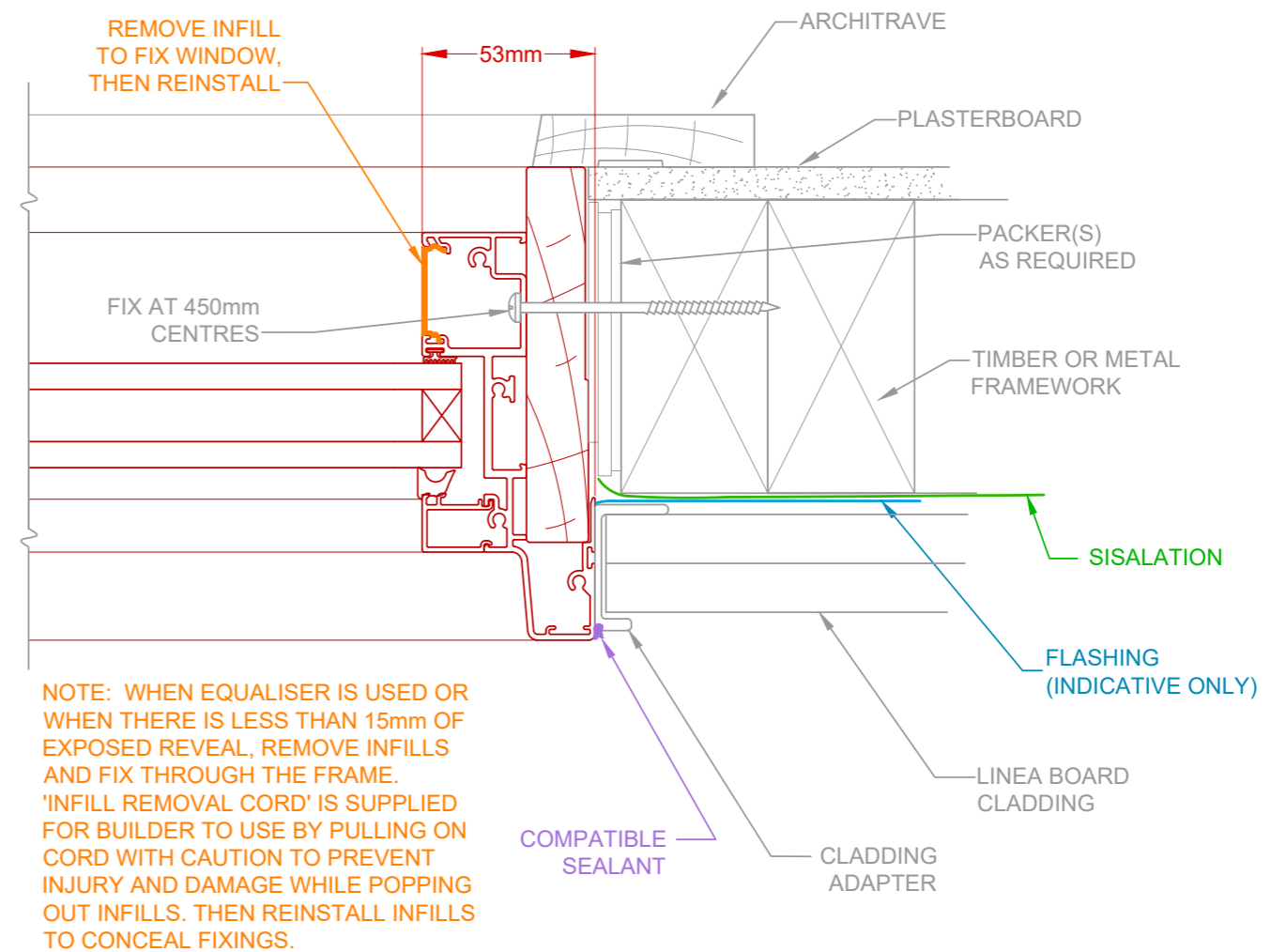

### SCAN QR CODE FOR INSTALLATION GUIDE

Technical Resources on this page include:

- 3D Interactive Renders
- Typical Building-In Detail CAD Drawings
- Link to the NCC (requires login)
- AGWA Fixing Guide (PDF download)



DRAWINGS NOT TO SCALE.  
INSTALLATION METHODOLOGIES DISPLAYED ARE A GUIDE ONLY.

The intellectual property on this drawing, copyright and patents are owned by Rylock Pty Ltd. All rights reserved. Refer to Standards & Codes for individual flashing and waterproofing requirements. CAD drawings are regularly updated & available at rylock.com.au



# Max Lite Window

COMMERCIAL SERIES - 125mm FRAME

## Head & Sill Detail

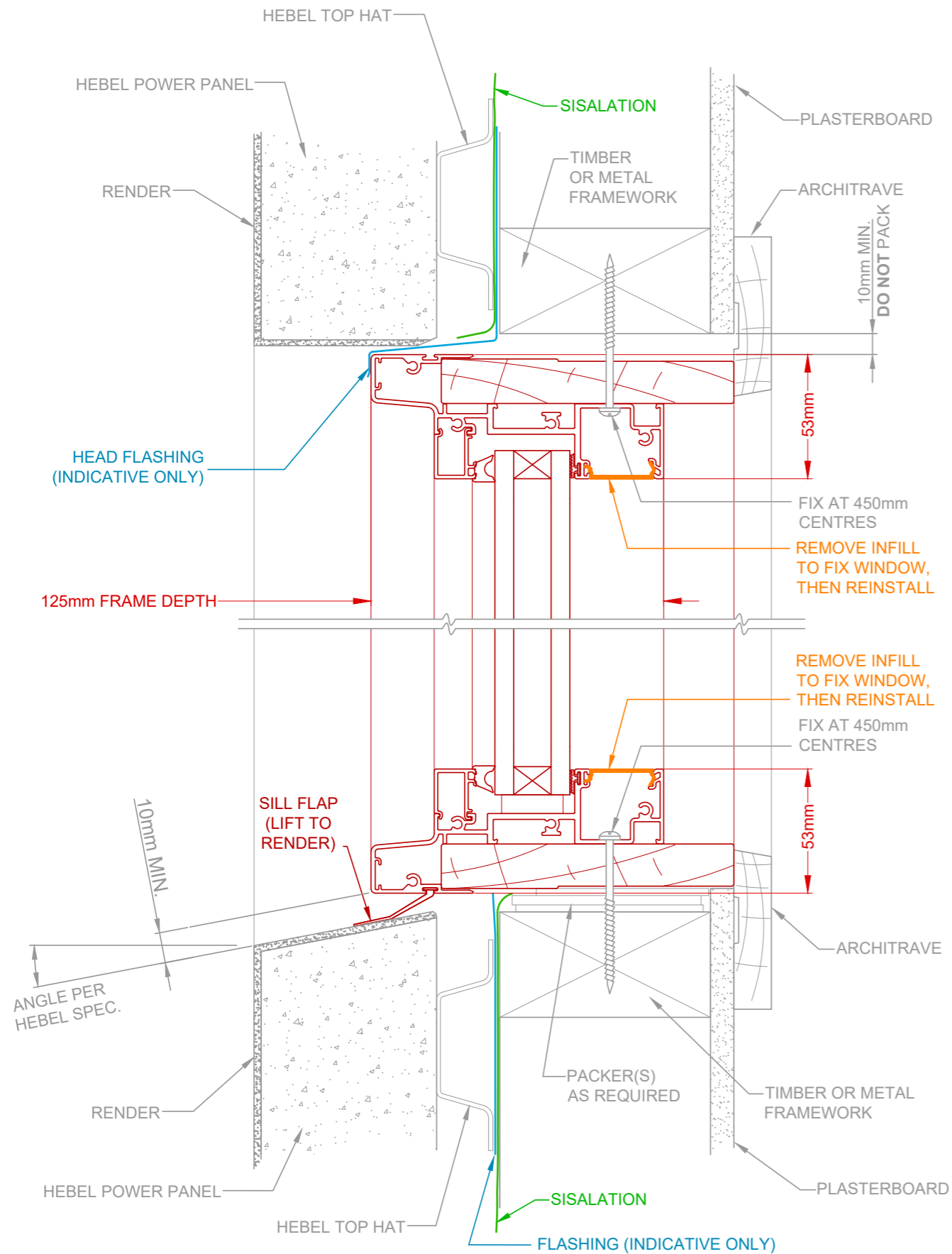

# Lightweight Cladding | Hebel PowerPanel

TYPICAL BUILDING-IN DETAIL

## Jamb Detail

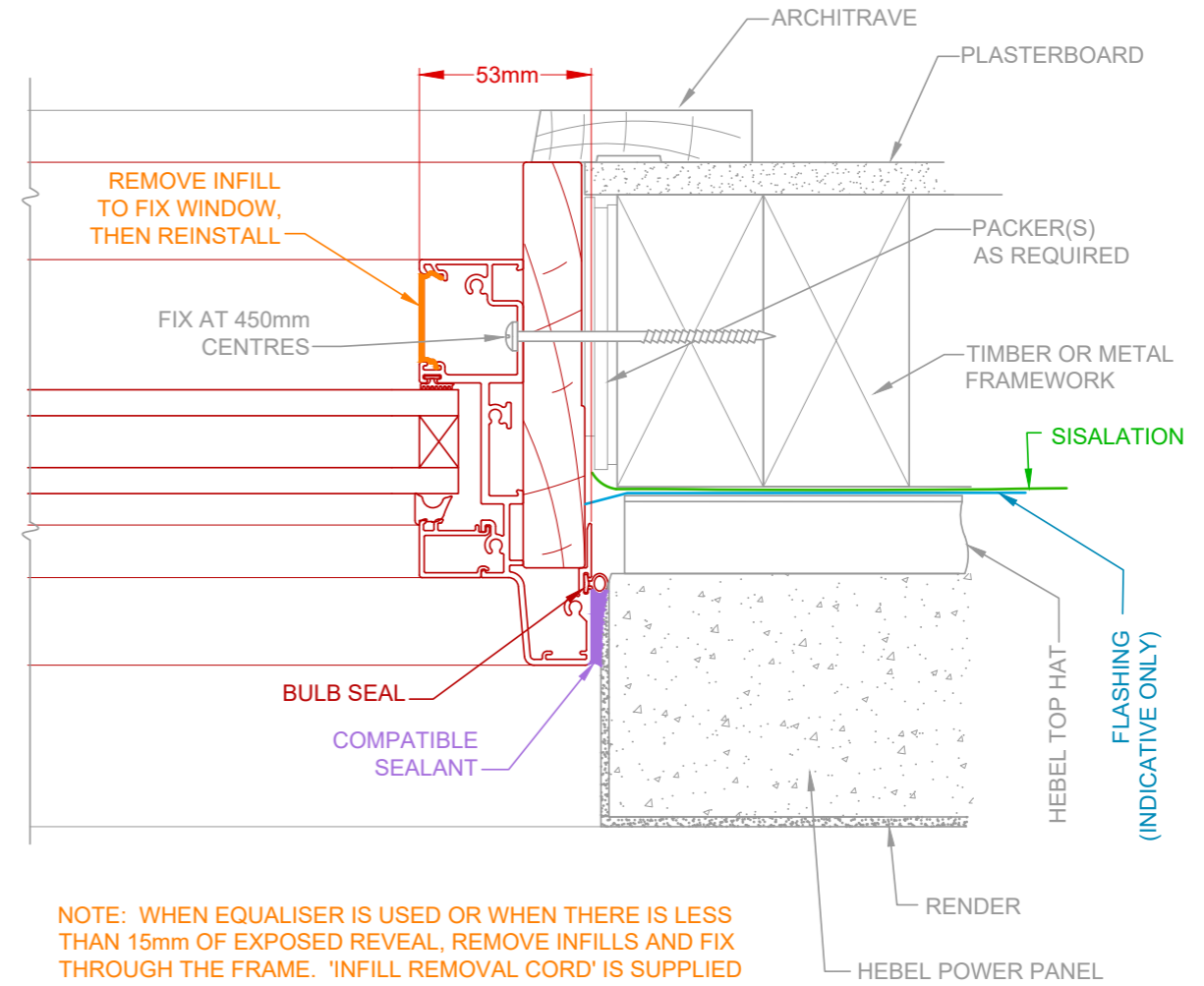

NOTE: WHEN EQUALISER IS USED OR WHEN THERE IS LESS THAN 15mm OF EXPOSED REVEAL, REMOVE INFILLS AND FIX THROUGH THE FRAME. 'INFILL REMOVAL CORD' IS SUPPLIED FOR BUILDER TO USE BY PULLING ON CORD WITH CAUTION TO PREVENT INJURY AND DAMAGE WHILE POPPING OUT INFILLS. THEN REINSTALL INFILLS TO CONCEAL FIXINGS.

### SCAN QR CODE FOR INSTALLATION GUIDE

Technical Resources on this page include:

- 3D Interactive Renders
- Typical Building-In Detail CAD Drawings
- Link to the NCC (requires login)
- AGWA Fixing Guide (PDF download)



DRAWINGS NOT TO SCALE. INSTALLATION METHODOLOGIES DISPLAYED ARE A GUIDE ONLY.

The intellectual property on this drawing, copyright and patents are owned by Rylock Pty Ltd. All rights reserved. Refer to Standards & Codes for individual flashing and waterproofing requirements. CAD drawings are regularly updated & available at rylock.com.au

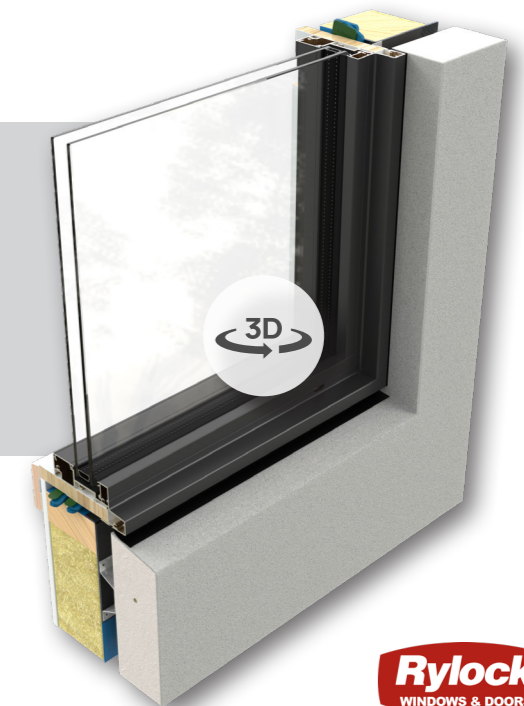

# Max Lite Window

COMMERCIAL SERIES - 125mm FRAME

# Brick Veneer

TYPICAL BUILDING-IN DETAIL

## Head & Sill Detail

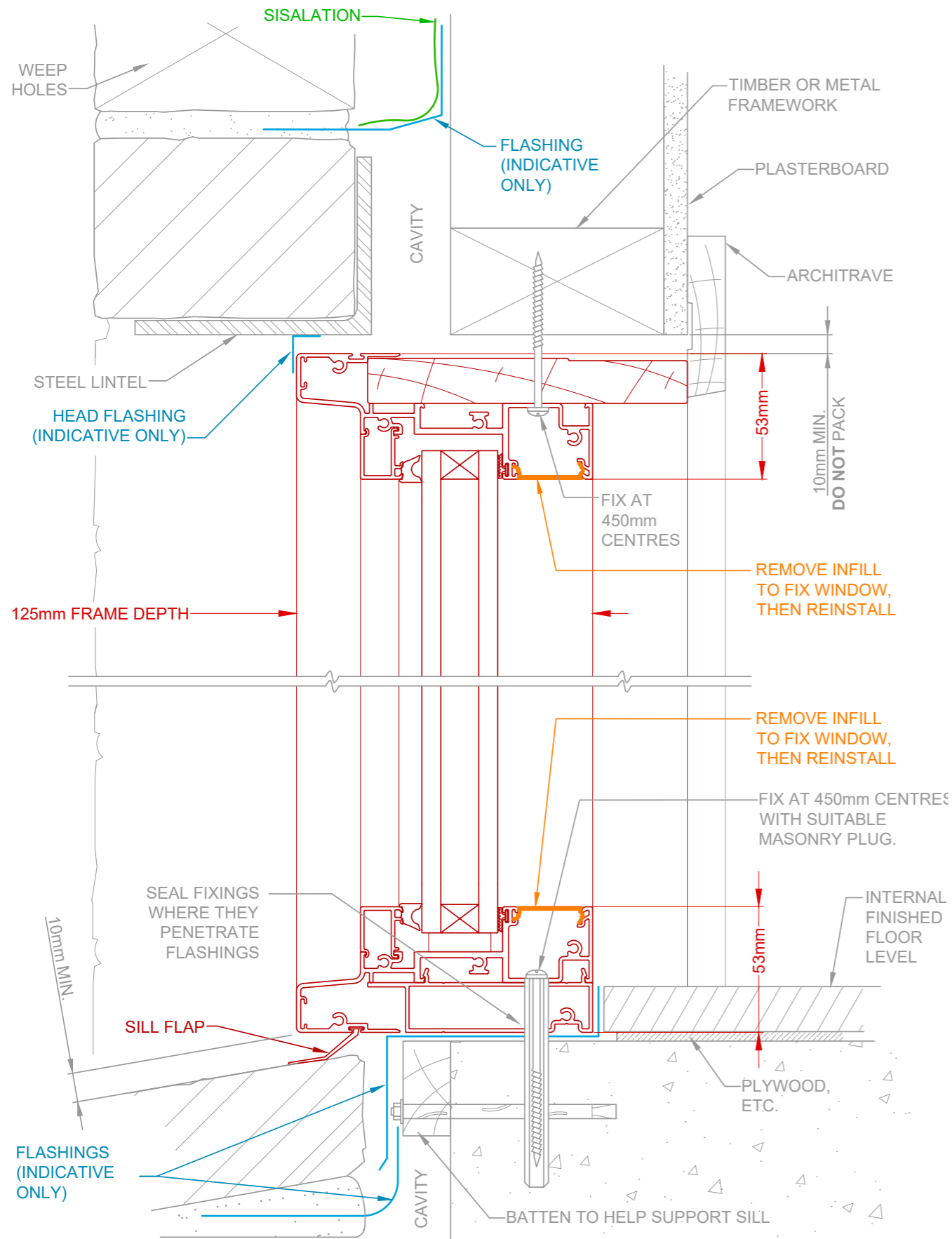

## Jamb Detail

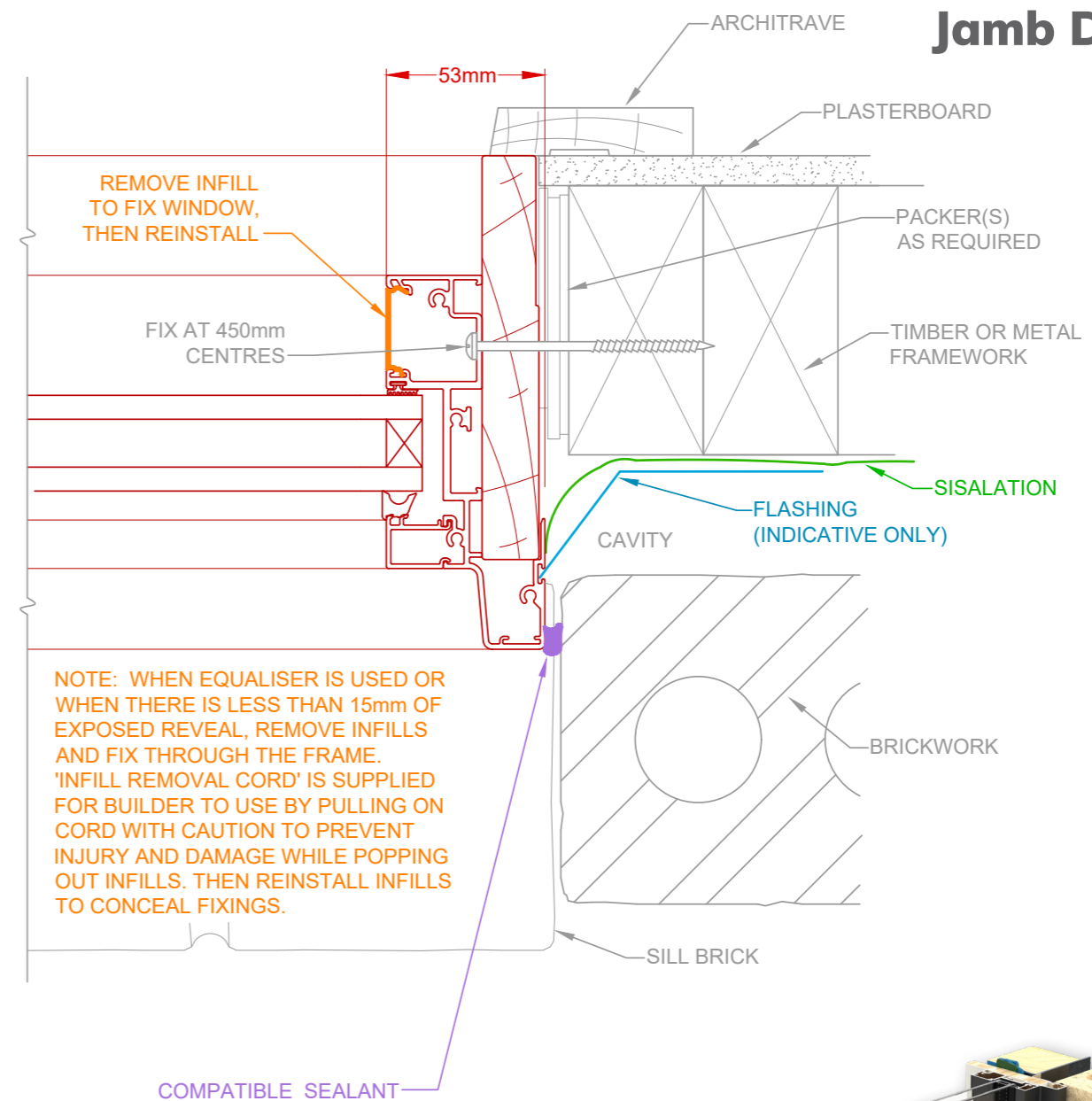

NOTE: WHEN EQUALISER IS USED OR WHEN THERE IS LESS THAN 15mm OF EXPOSED REVEAL, REMOVE INFILLS AND FIX THROUGH THE FRAME. 'INFILL REMOVAL CORD' IS SUPPLIED FOR BUILDER TO USE BY PULLING ON CORD WITH CAUTION TO PREVENT INJURY AND DAMAGE WHILE POPPING OUT INFILLS. THEN REINSTALL INFILLS TO CONCEAL FIXINGS.

### SCAN QR CODE FOR INSTALLATION GUIDE

Technical Resources on this page include:

- 3D Interactive Renders
- Typical Building-In Detail CAD Drawings
- Link to the NCC (requires login)
- AGWA Fixing Guide (PDF download)



DRAWINGS NOT TO SCALE. INSTALLATION METHODOLOGIES DISPLAYED ARE A GUIDE ONLY.

The intellectual property on this drawing, copyright and patents are owned by Rylock Pty Ltd. All rights reserved. Refer to Standards & Codes for individual flashing and waterproofing requirements. CAD drawings are regularly updated & available at rylock.com.au



# Max Lite Window

COMMERCIAL SERIES - 125mm FRAME

Double Brick

TYPICAL BUILDING-IN DETAIL

## Head & Sill Detail

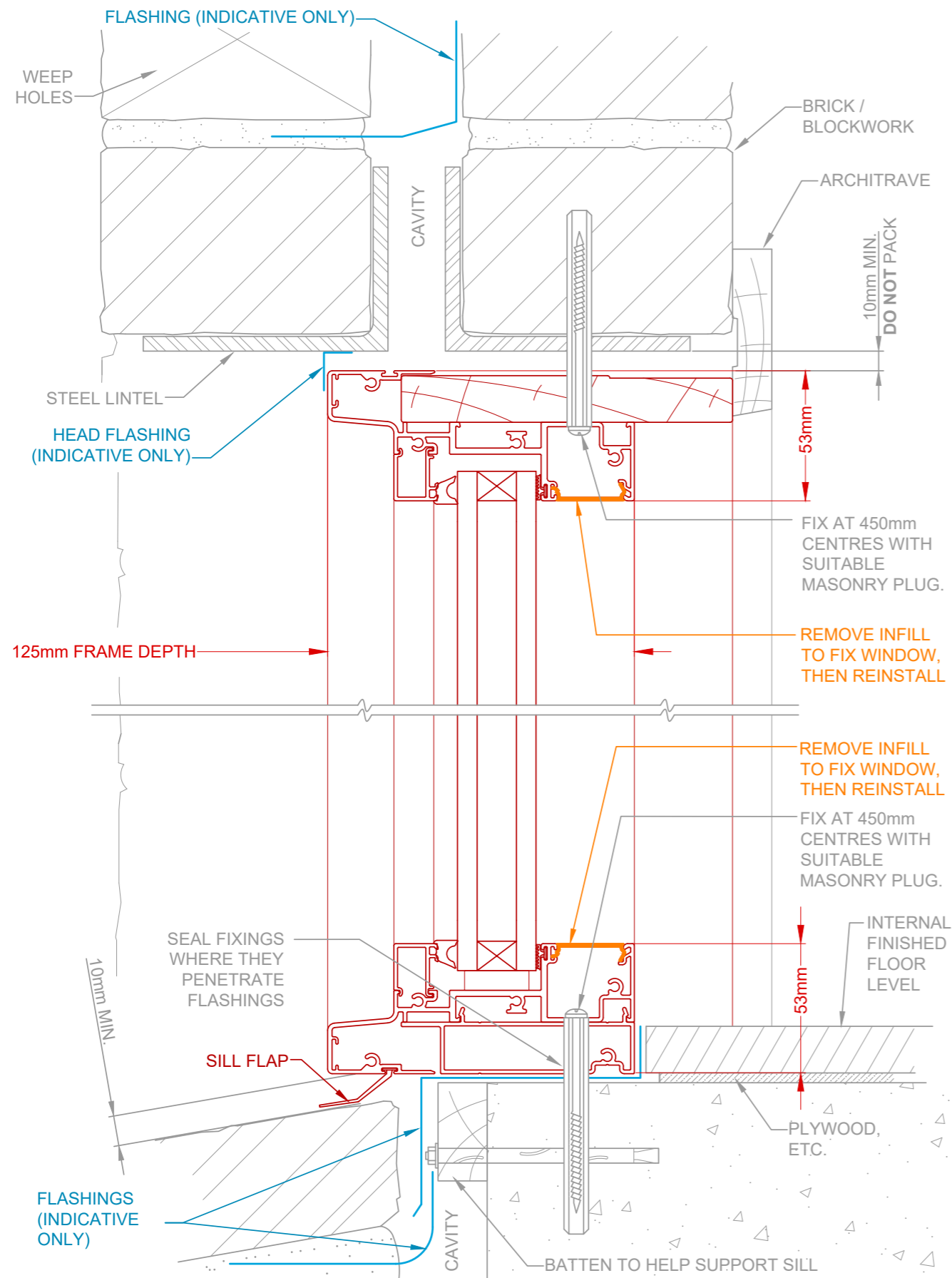

## Jamb Detail

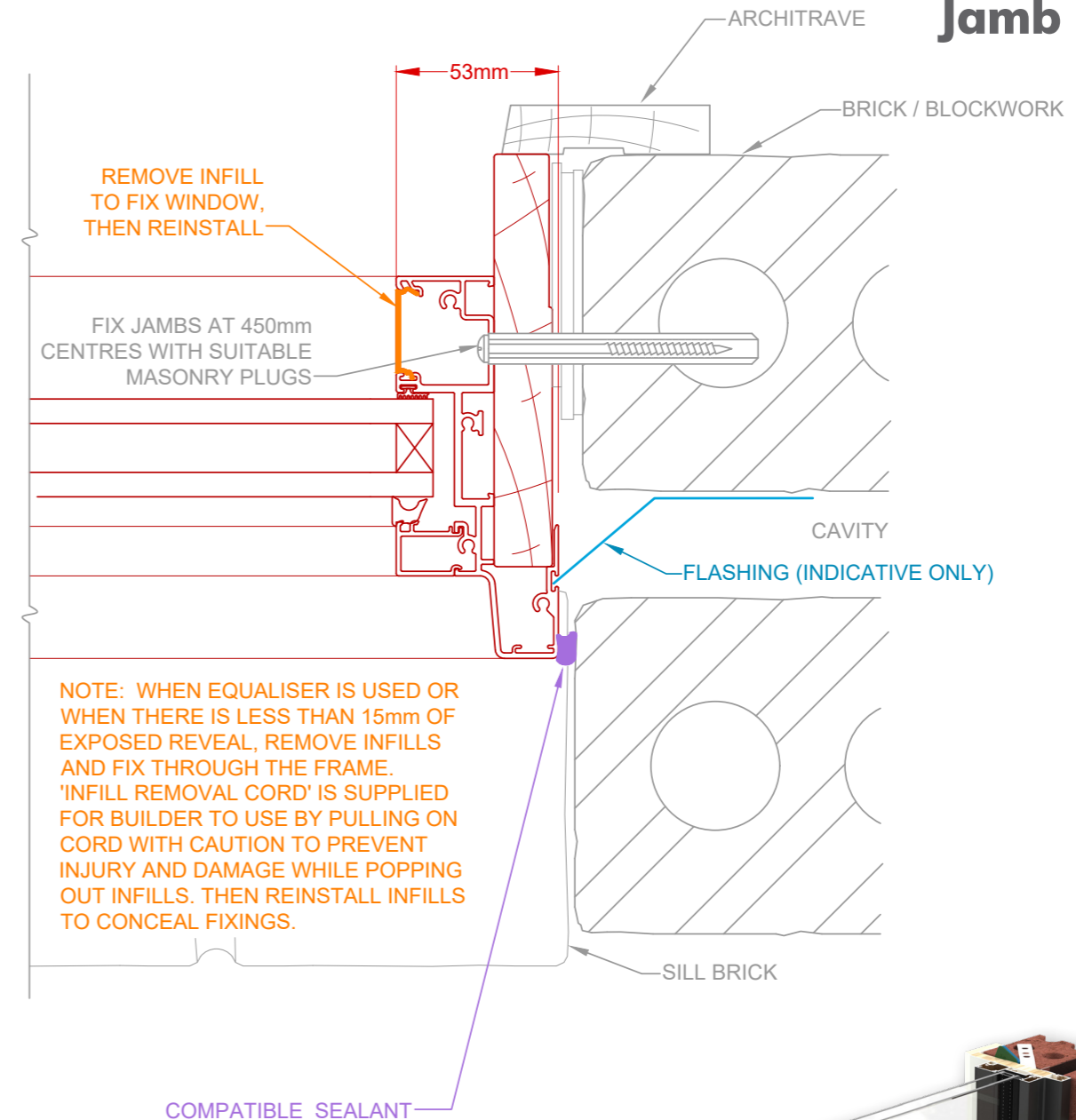

### SCAN QR CODE FOR INSTALLATION GUIDE

Technical Resources on this page include:

- 3D Interactive Renders
- Typical Building-In Detail CAD Drawings
- Link to the NCC (requires login)
- AGWA Fixing Guide (PDF download)



DRAWINGS NOT TO SCALE.  
INSTALLATION METHODOLOGIES DISPLAYED ARE A GUIDE ONLY.

The intellectual property on this drawing, copyright and patents are owned by Rylock Pty Ltd. All rights reserved. Refer to Standards & Codes for individual flashing and waterproofing requirements. CAD drawings are regularly updated & available at rylock.com.au

